

STATE OF NORTH CAROLINA
DEPARTMENT OF TRANSPORTATION
HIGHWAY DIVISION 6

PLANS

Letting Date: FEBRUARY 5, 2025

CONTRACT ID: DF00501

TIP NO.: HS-2406A, HS-2406G, HS-2406J & HS-2406L

FEDERAL AID NO.: HSIP-5097801, HSIP-5097807, HSIP-5097810, HSIP-5097812

WBS ELEMENT NO.: 50978.3.2, 50978.3.8, 50978.3.11, 50978.3.13

ROUTE NO.: NC 87, US 701, NC 130 AND US 301

LOCATION: VARIOUS

COUNTY: BLADEN, COLUMBUS AND ROBESON

LENGTH OF PROJECT: 79.865 MILES

TYPE OF WORK: SINUSOIDAL MILLED RUMBLE STRIPES & PAVEMENT MARKINGS

5/26/20

PROJECT SHEET
HS-2406A
SINGLE SCALE

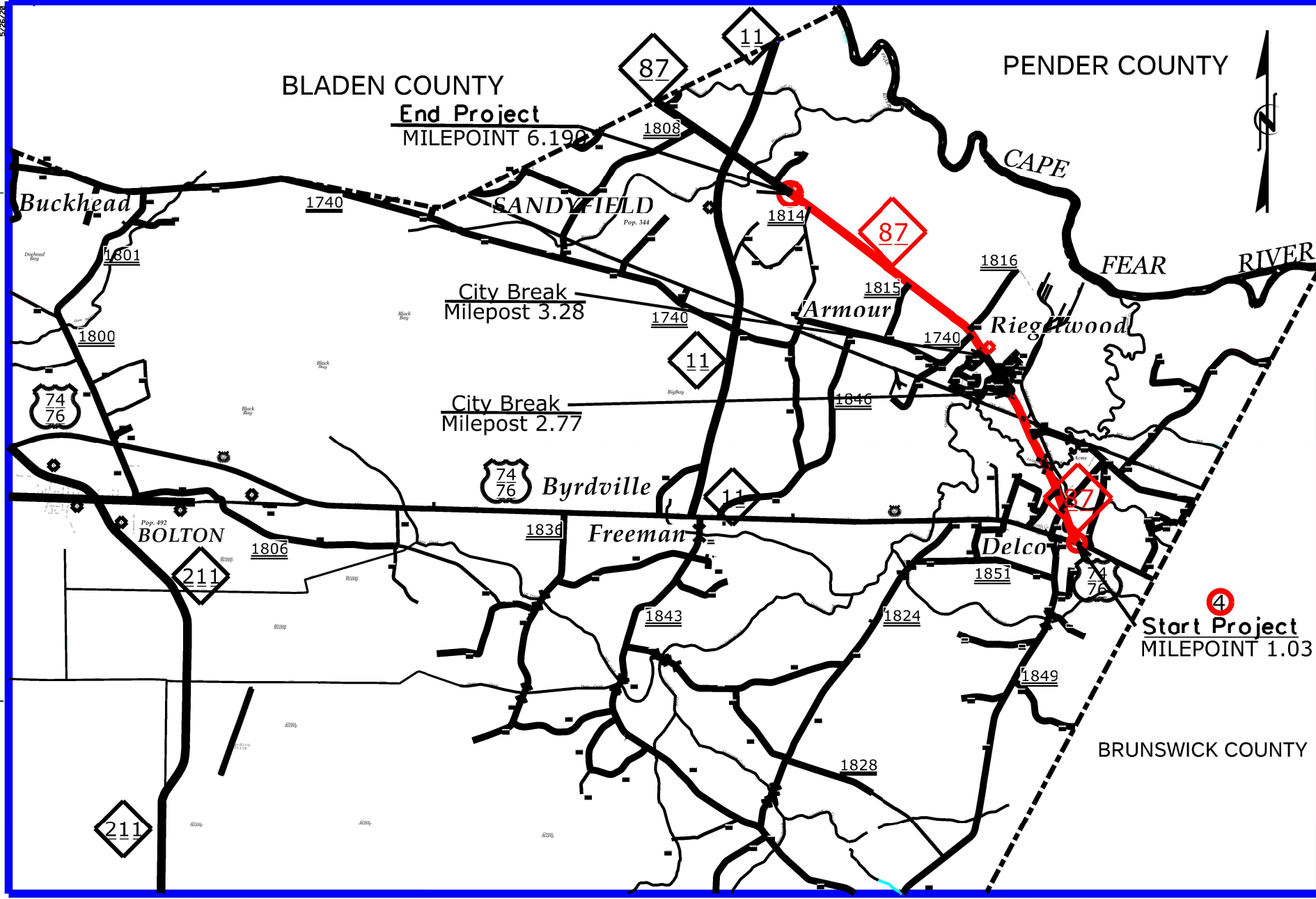

HS-2406A

④

Start Project
MILEPOINT 1.03

End Project
MILEPOINT 6.190

PENDER COUNTY

BLADEN COUNTY

BRUNSWICK COUNTY

HS-2406G

5/25/20

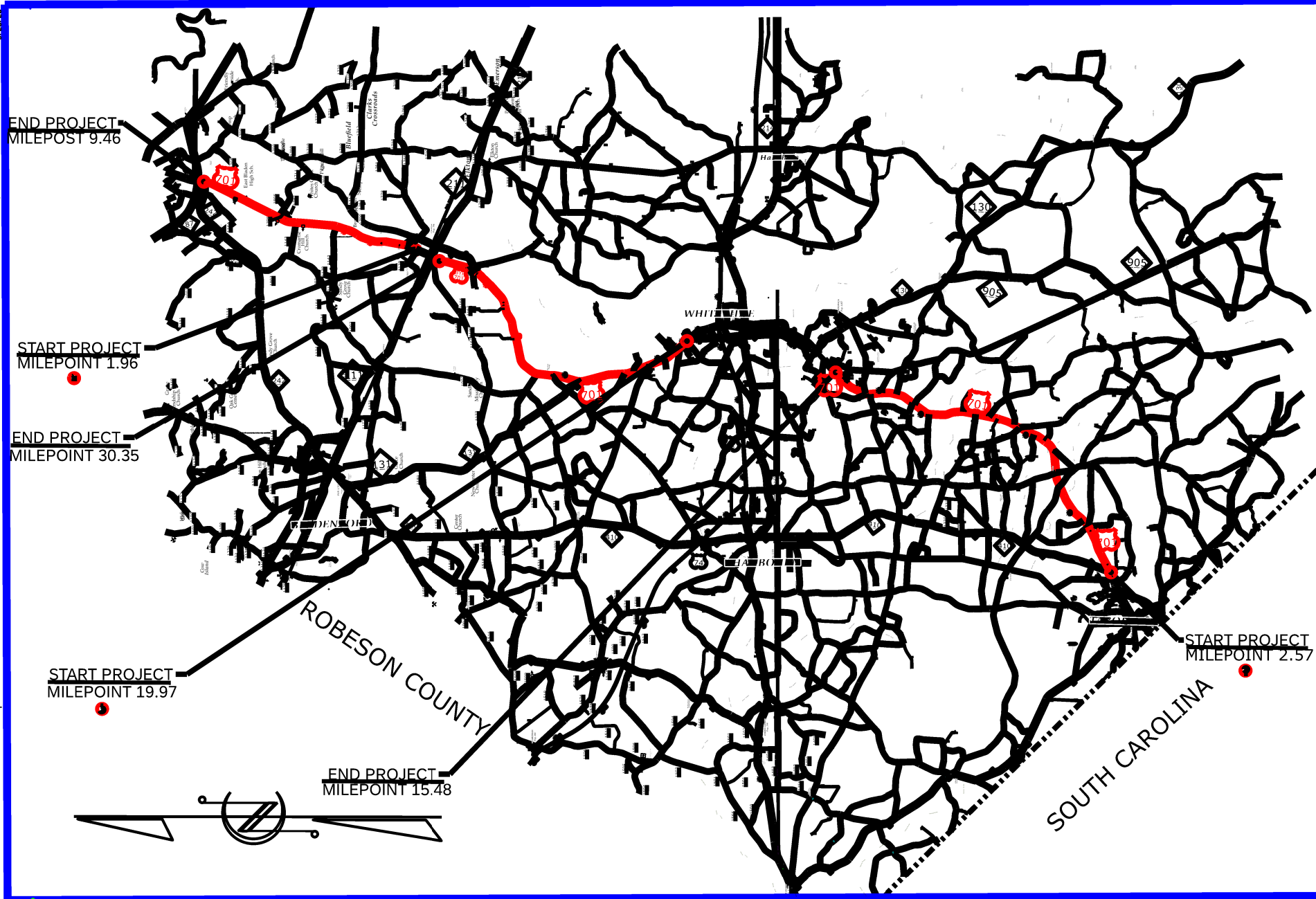

END PROJECT
MILEPOST 9.46

START PROJECT
MILEPOST 1.96

END PROJECT
MILEPOST 30.35

START PROJECT
MILEPOST 19.97

END PROJECT
MILEPOST 15.48

START PROJECT
MILEPOST 2.57

ROBESON COUNTY

SOUTH CAROLINA



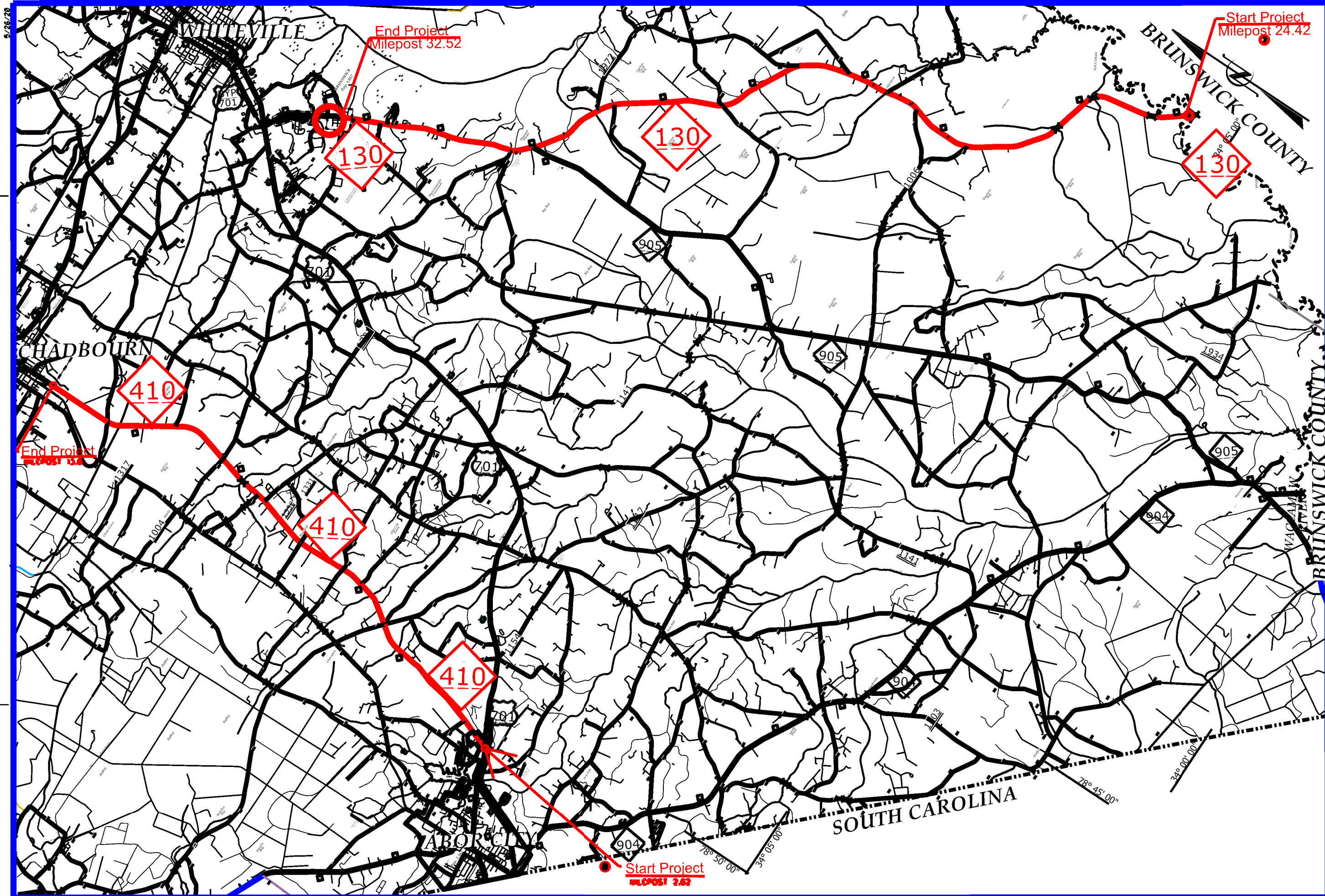

End Project
Milepost 32.52

Start Project
Milepost 24.42

End Project
Milepost 3.72

Start Project
Milepost 2.62

PROJECT# SHEET#
HS-2406J 1
INCH TO 1 MILE SCALE

HS-2406J

5/26/20

WHITEVILLE

BRUNSWICK COUNTY

CHADBOURN

BRUNSWICK COUNTY

ABBEVILLE

SOUTH CAROLINA

130

130

130

410

410

410

904

905

905

905

904

90

1004

701

701

701

1934

103

1141

1141

1072

1006

78° 45' 00"

78° 50' 00"

34° 03' 00"

24° 00' 00"

HS-2406L

START PROJECT
MILEPOINT 24.42

7

HOKE COUNTY

CUMBERLAND COUNTY

END PROJECT
MILEPOINT 40.92

START PROJECT
MILEPOINT 33.86

8

BLADEN COUNTY

BLADEN COUNTY

END PROJECT
MILEPOINT 32.52

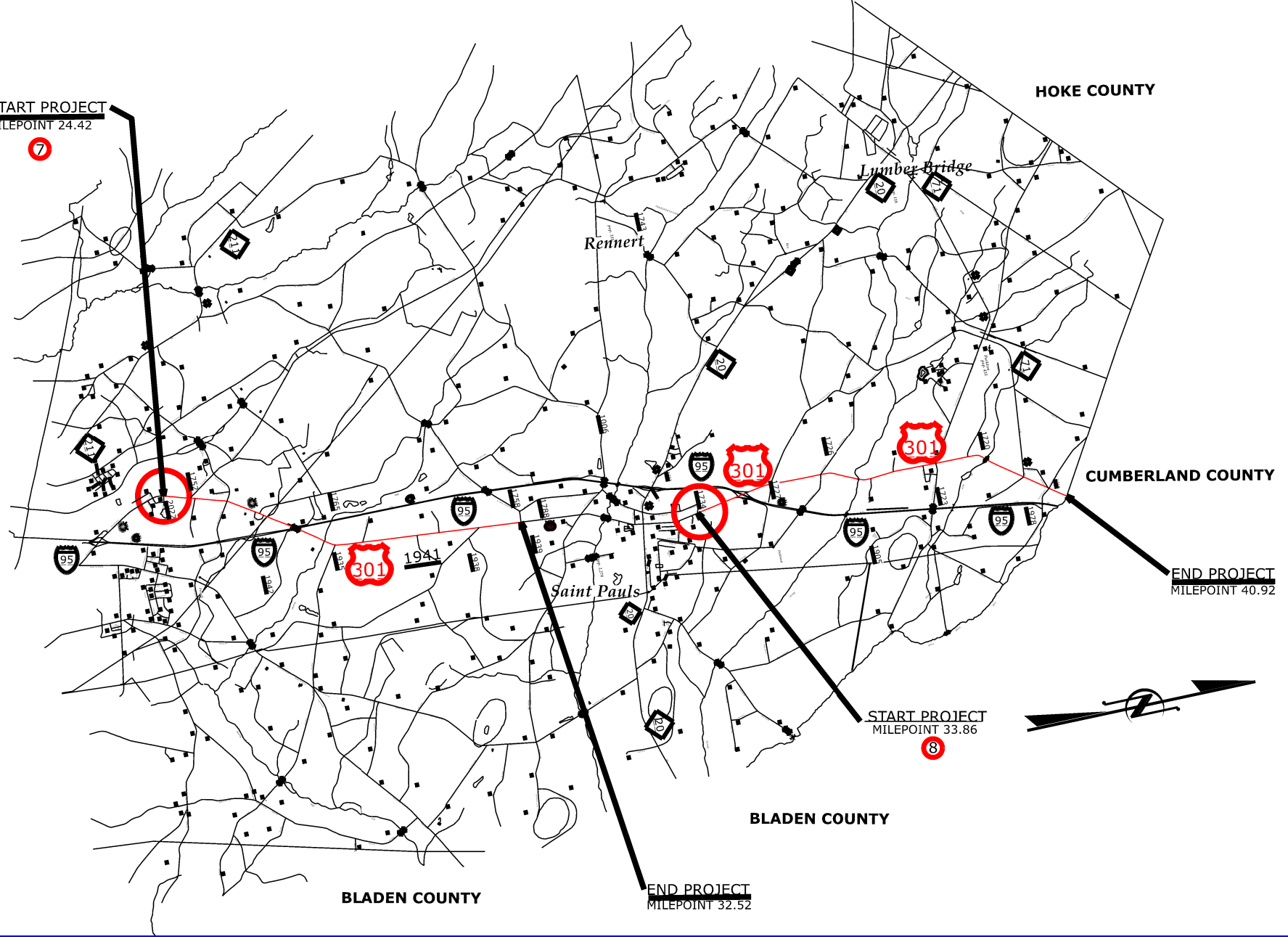

County	Map_Number	Route_ID	Description	From	To	WBS	TIP
Bladen	1	20000701009	US 701 Center and Edge Line Rumbles with 6" long life pavement markings, and raised pavement markers in Bladen County	1.96	9.46	50978.1.8	HS-2406G
Columbus	2	20000701024	US 701 Center and Edge Line Rumbles with 6" long life pavement markings, and raised pavement markers in Columbus County	2.57	15.48	50978.1.8	HS-2406G
Columbus	3	20000701024	US 701 Center and Edge Line Rumbles with 6" long life pavement markings, and raised pavement markers in Columbus County; Includes removal of edgeline pavement markings	19.97	30.35	50978.1.8	HS-2406G
Columbus	4	30000087024	NC 87 Center and Edge Line Rumbles with 6" long life pavement markings, and raised pavement marker Columbus County; Includes removal of edgeline pavement markings	1.033	6.19	50978.1.2	HS-2406A
Columbus	5	30000410024	NC 130 install rumble stripes , 6" long life pavement markings and raised pavement markers in Columbus County	0	17.04	50978.1.11	HS-2406J
Columbus	6	29000074024	NC 410 install rumble stripes , 6" long life pavement markings and raised pavement markers in Columbus County	2.62	13.6	50978.1.11	HS-2406J
Robeson	7	20000301078	US 301 install rumble stripes , 6" long life pavement markings and raised pavement markers in Robeson County	24.42	32.52	50978.1.13	HS-2406L
Robeson	8	20000301078	US 301 install rumble stripes , 6" long life pavement markings and raised pavement markers in Robeson County	33.865	40.92	50978.1.13	HS-2406L

See Table 1 within Rumble Strip Policy for Design Guidance

PLAN VIEW

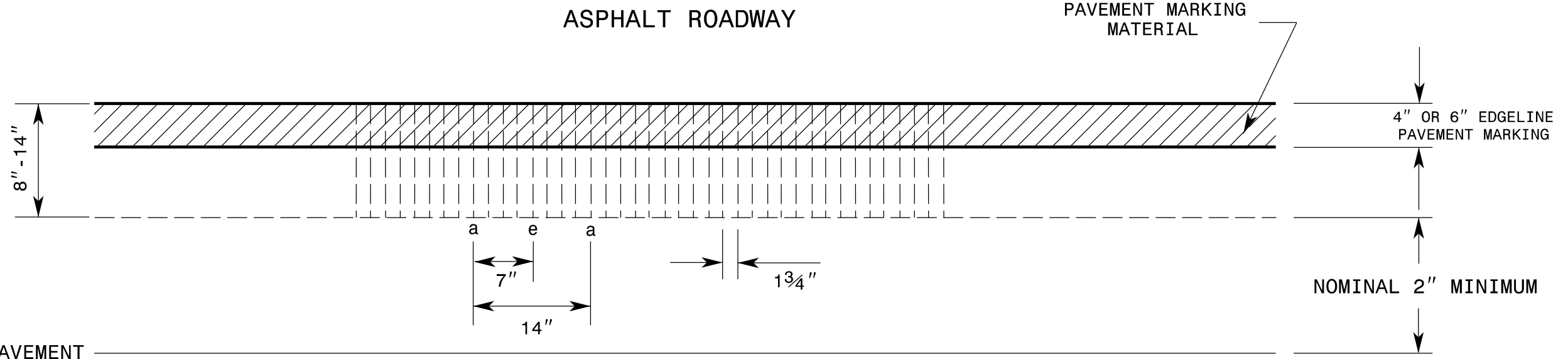
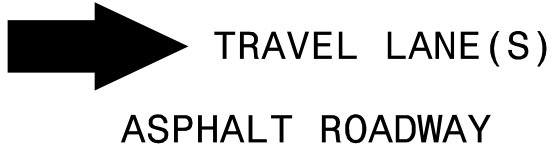

PROFILE VIEW

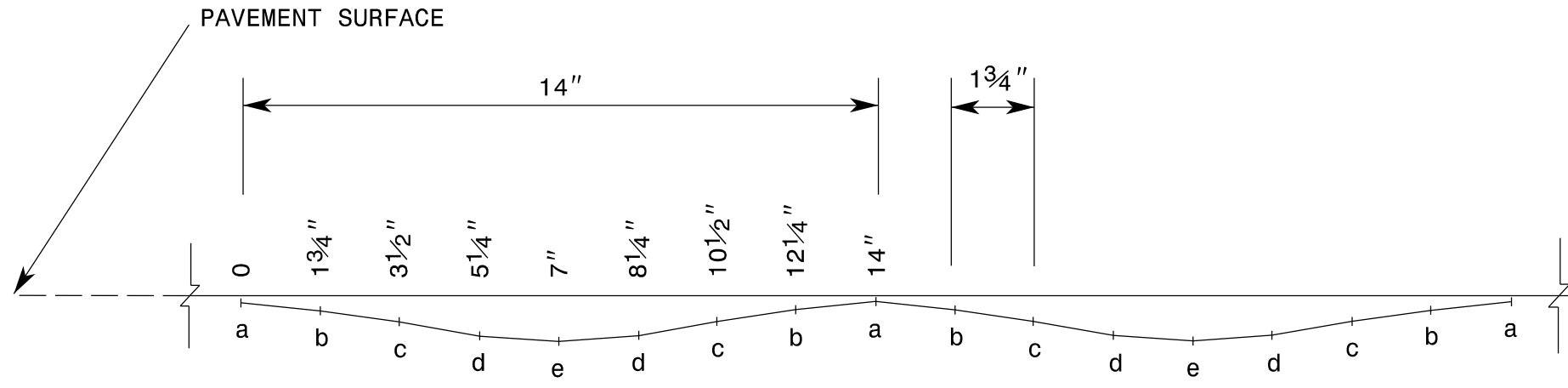

LOCATION	DEPTH	
	MIL	INCHES
a	62.5	1/16"
b	125	1/8"
c	219	7/32"
d	344	11/32"
e	375	3/8"

REFERENCE DRAWING ID: Sin.Stripe

DRAFT REFERENCE DRAWING: FEBRUARY 2023

NOTES:

- 1) Specification in table taken from MNDOT Research Project Final Report 2016-23: *Sinusoidal Rumble Strip Design Optimization Study By: Terhaar et. al, June 2016*
- 2) USING A VACUUM, REMOVE ALL DEBRIS FROM THE MILLINGS JUST PRIOR TO PLACING ANY PAVEMENT MARKINGS.
- 3) ENSURE GLASS BEADS ARE SPREAD UNIFORMLY OVER THE ENTIRE SURFACE OF THE PAVEMENT MARKING MATERIAL.

See Table 2 within Rumble Strip Policy for Design Guidance

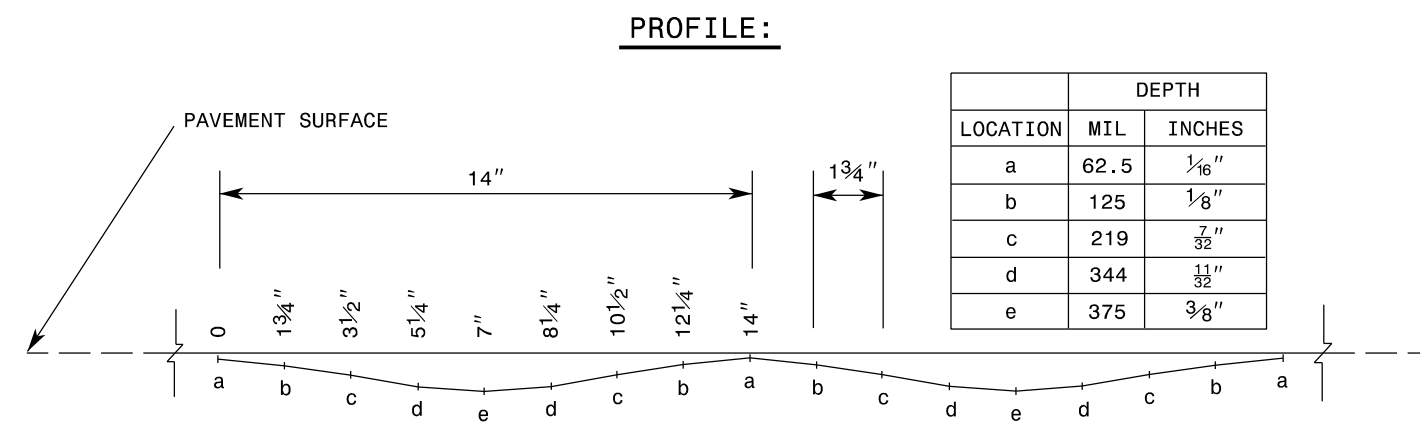
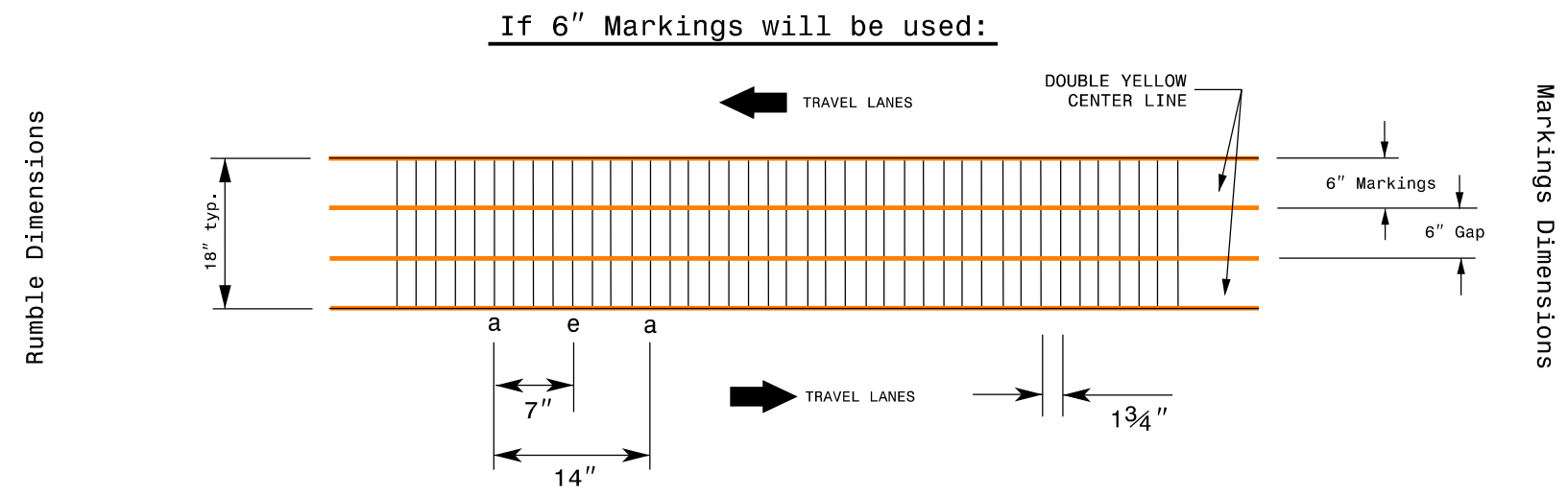
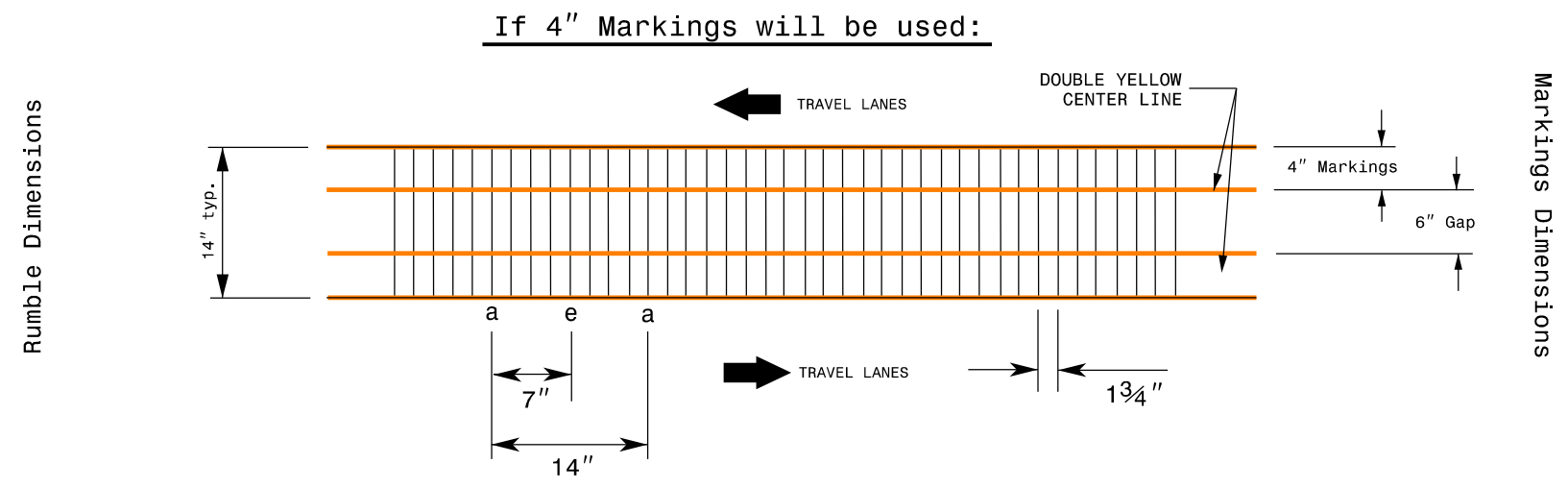

REFERENCE DRAWING ID: Sin.CL

DRAFT REFERENCE DRAWING: FEBRUARY 2023

NOTES:

- 1) Specification in table taken from MNDOT Research Project Final Report 2016-23: *Sinusoidal Rumble Strip Design Optimization Study By: Terhaar et. al, June 2016*
- 2) USING A VACUUM, REMOVE ALL DEBRIS FROM THE MILLINGS JUST PRIOR TO PLACING ANY PAVEMENT MARKINGS.
- 3) ENSURE GLASS BEADS ARE SPREAD UNIFORMLY OVER THE ENTIRE SURFACE OF THE PAVEMENT MARKING MATERIAL.